

77 Baldock Road
Current Front

scale  1 FT

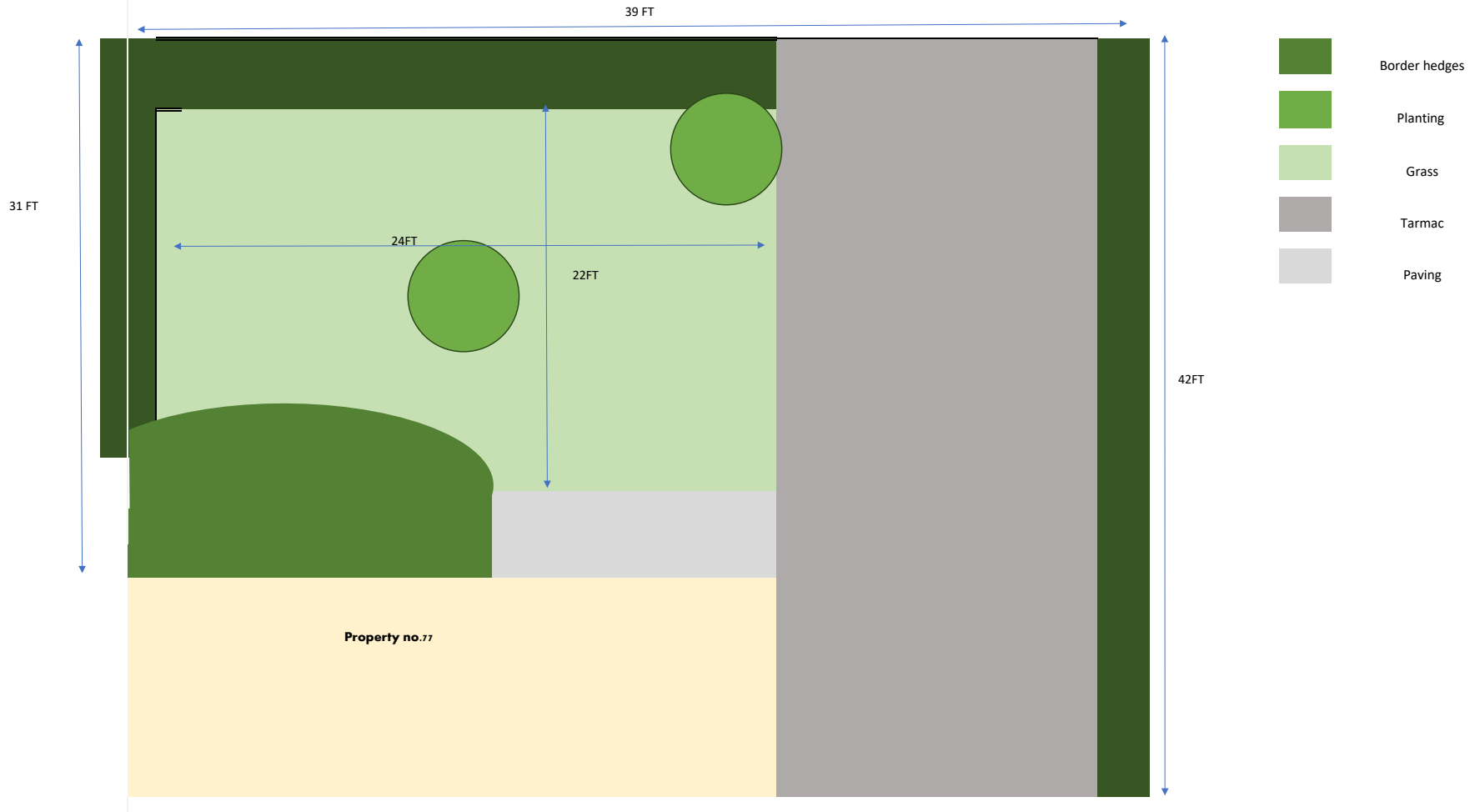

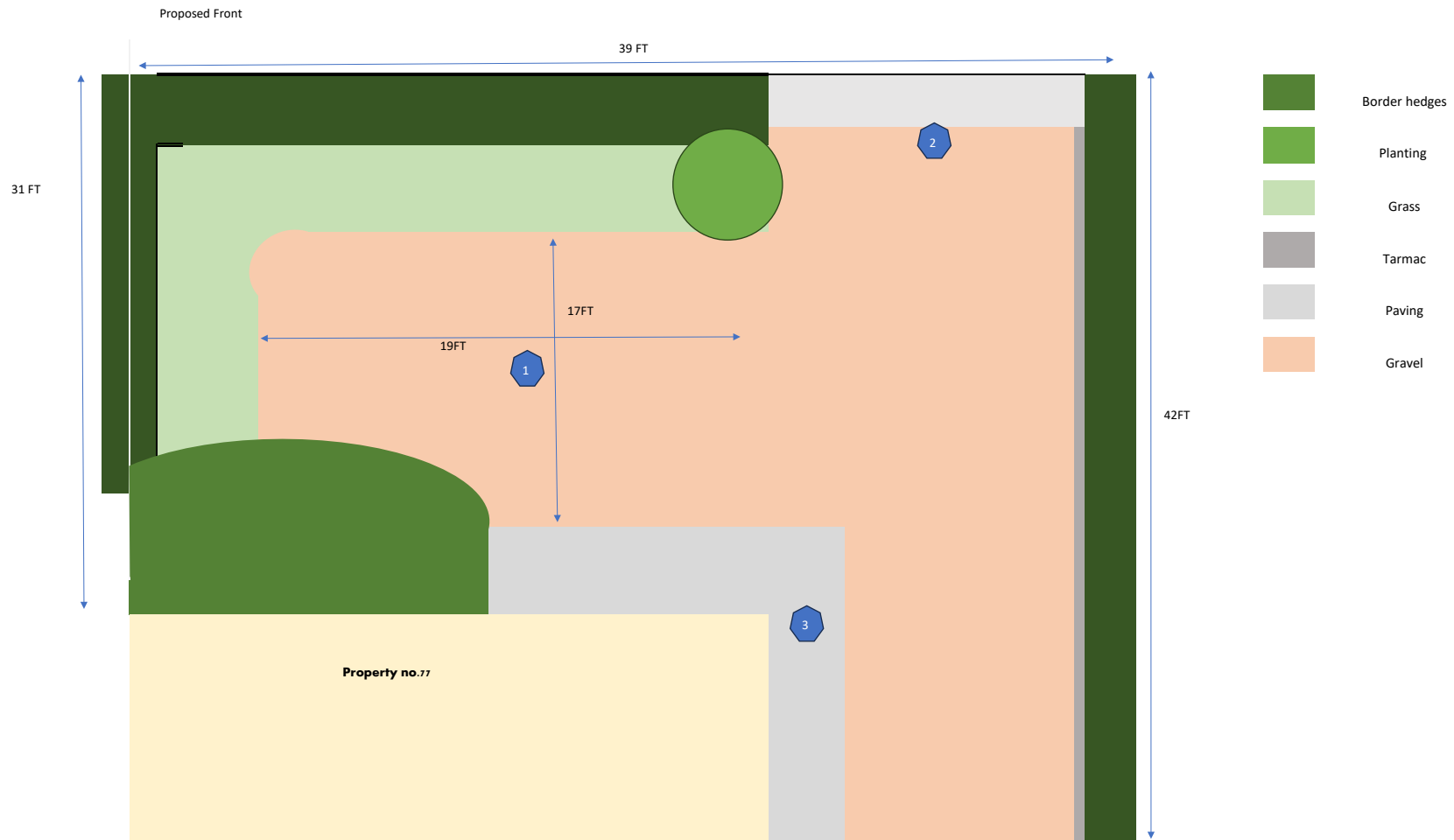

Notes

1. 17FT X 19FT grass replaced by gravel: enabling cars to be parked and turned so that driveway can be exited in forward rather than needing to reverse from and to Baldock Road. Noting current visibility due to hedges is dangerous severely limiting view of pedestrians, cyclists on pavement and limiting sight of traffic. 1 accident in the past 12 months.
2. Gravel to be laid replacing tarmaced driveway, aesthetically harmonising the two areas, block paving strip to be added at end of driveway to prevent gravel spilling onto pavement.
3. Paving path connecting existing steps to front door to the side gate